

Location  
Béziers

Clients  
APIJ, Agence Publique pour l'Immobilier de la Justice

Team  
Ateliers 2/3/4/ (architect + interior design) - CET (engineer) - Tournesol (landscape designer) - Guliver design (creation of a range of tertiary furniture for RIEP (Régie Industrielle des Etablissements Pénitentiaires)) - Guliver design (signage design)

Nature of the project  
Public equipment, Interior design

Program  
Construction of the new courthouse: high court, county court, commercial court, employment tribunal, courtrooms, tertiary and shared spaces

Awards/Distinctions  
Best Architects 2017 Label  
Winner of Trophée Béton Pro 2017  
Architizer A+Awards: Finalist in the "Government & Municipal Buildings category"

Status  
Built

Area  
8 057 m<sup>2</sup>

Calendar  
Completion may 2016

Cost  
16.5 M€

Construction compagnies  
Groupement SOGEA SUD (general contractor) - Romain Taïeb (texture artist)

Credits  
©CharlyBroyez / ©WeAreContents  
video : ©WeAreContents



To provide the urban monumentality required of a judicial institution and the serenity necessary to handle delicate cases that affect people's lives, the new Béziers Court is seen as stacks of three layers of rock. At each level, steps and patios locate between these quarry blocks. The stepped masses encourage daylight to enter, creating internal landscapes, like an oasis. They to protect the premises from any intrusive view. As such, security of the facades and confidentiality are attained with ease.

The transparency of the foyers gives glimpses of the shady central patio garden, planted with tree ferns, that accesses and links the public waiting areas and courtrooms.  
Built-in furniture within public areas and

office furniture have been designed to ensure comfort and to fit in perfectly with the volumes of the reception and work areas.  
Monochrome, through its irregularities the sandblasted and hammered concrete gives a rustic material strength and thickness. A symbol of justice, the parvis is here an antechamber, the sheltered outside institution; open to urban life it soothes, protects and welcomes.

légendes

- 01 Palais de Justice - Béziers - 234 Architecture
- 02 Autre légende pour une image
- 03 Plan rdc

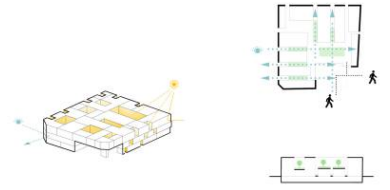

01

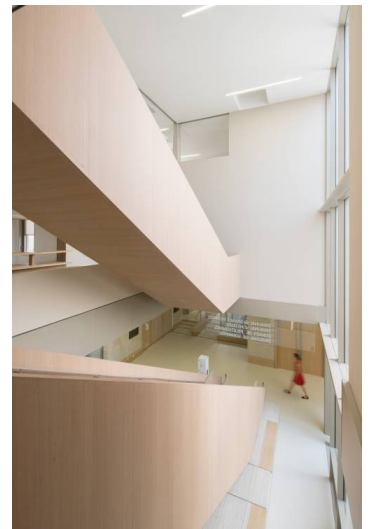



02



03