

Location
Paris

Clients
BNP Paribas Real Estate

Team
Ateliers 2/3/4/ (architect)

Nature of the project
Tertiary, Research

Program
Osmoz Campus, research for BNP Paribas Immobilier
Offices, library, fitness, concierge service, amphitheater, conference rooms, social rooms, lounge, café

Status
Competition

Area
50 000 m²

Calendar
Study 2013



To avoid any monolithic expression that evokes a single functional entity, the overall volume was split into 5 separate and distinct buildings to facilitate travel between buildings within the overall project just as on a university campus.

Another feature of the volumetric composition is to reveal the rich inner landscape to neighbors. Thus, the project opens generously onto the surrounding public space by various means (voids, transparency, breach, urban lodges).

Environmental Ambitions

Here sustainable development takes its meaning from the notions of comfort (or well-being) and harmony associated with these new workplace proposals where the air quality, daylight and planting within the internal landscaping project play a key role.

légendes

- 01 fitness
- 02 amphithéâtre
- 03 bibliothèque

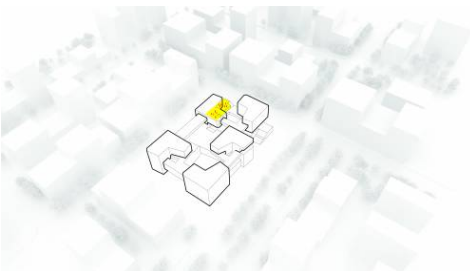
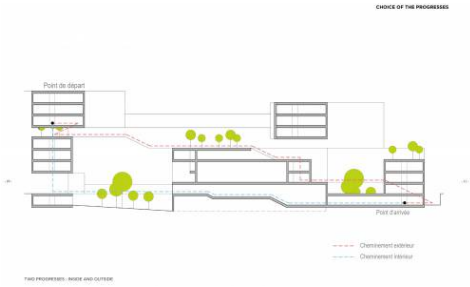

01

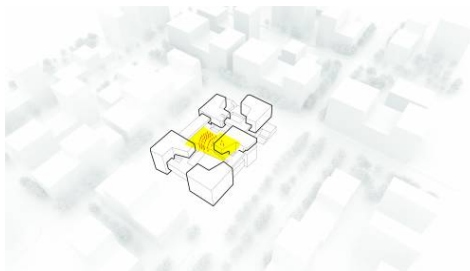

02

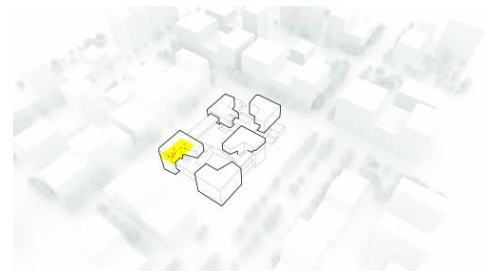

03



